



General specifications

PHYSICAL SPECIFICATIONS	
Tunnel width	600mm
Tunnel Height	500mm
Machine Size	LxWxH: 2740x1490x2000mm
Machine Weight	500kg
Material	SUS304
Material	Food grade PU
Belt width	600mm
Height to ground	850±50mm
Speed	10~40m/min
Weighing Range	50kg
Voltage	120kv
X -ray current	200-5000µA
X -ray power	500W
Detector	0.2mm
Fe/SUS etc. metal ball (Φ)	0.2mm
Fe/SUS etc. metal ball strip	0.1x2mm
Glass ball (Φ)	0.4 mm
Ceramic ball (Φ)	0.4 mm
Fish bone (Φ)	0.2 mm
Algorithm support	Foreign body detection
Protection level	Transmission part : IP66 Other areas : IP54
Tested product form	Packaging, bulk materials
Rejection	Stop and alarm
Alarm	Ring and light
Display	21.5 touch screen
Cooling method	Industrial air conditioner
Protection method	4 layers of protective curtains
Radiation safety	≤1µSv/h
Voltage	AC110V/220V-240V,50/60HZ 1phase AC400V, 3 phase
Temperature	-10~40°C
Working humidity	30~90%RH
Included interfaces	Ethernet, USB; support MES docking



Application

AI-powered X-ray inspection system for detecting metal, hard plastic, ceramic, glass, bones, and other foreign contaminants in large cartons up to 900 × 601 × 160 mm or 900 × 397 × 340 mm.

Ideal for food, garments, footwear, textiles, and agricultural products. Especially suitable for aluminum-packaged products, sports shoes, handbags, and garments with zippers, where conventional metal detectors are ineffective.



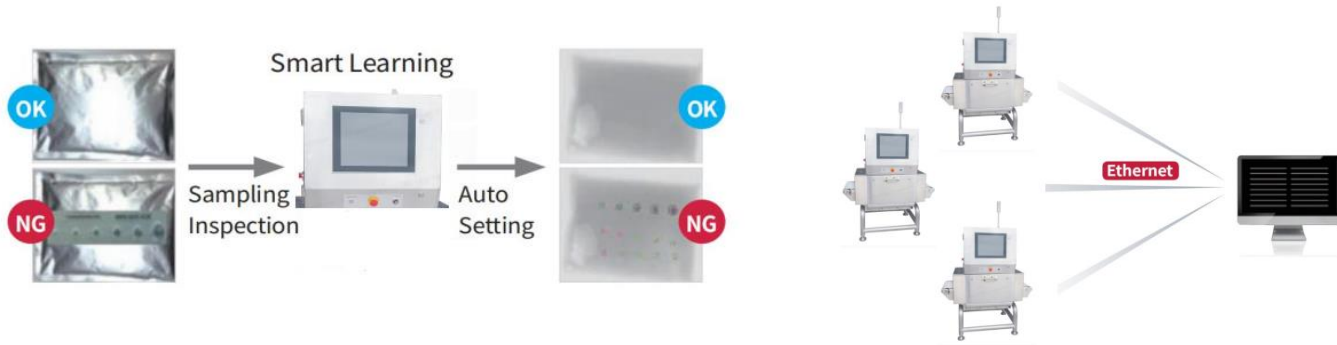

Dimensions

